

1	Castor	4
2	Screw guide sleeve	2
3	Foot	2
4	JSDR1-2-500 / 650-0-B-V	2
5	Lite side bracket	2
6	Lite frame L	2
7	Lite frame R	2
8	M6x12 flange machine screw	8
9	M8-1.25x8WM set screw	2
10	Rubber washer waist shape	4
11	Screw clip	2
12	M6-14 Machine screw	8
13	ST5-16 wooden screw	8
14	TF-D7 Rubber washer	2
15	TF-D7 Rubber washer-5mm	2
16	0.9m connect cable	1
17	Cable click 70mm-0-ATC-17 white	5
18	Velcro sticker, Hair surface-85x50	1
19	Velcro sticker, Hook surface-85x50	1
20	Allen wrench - 4mm / 5mm	1

Lift capacity 80 kg evenly

SCAN SØRLIE
NEW NORDIC DESIGN



SCAN SØRLIE
NEW NORDIC DESIGN

Frame Structure: Dual frame, elegant, durable and adjustable

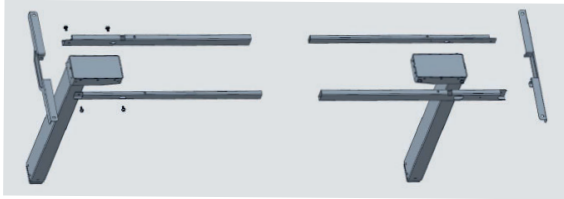

Details:

1. Pre-install screws to assemble the frame and columns

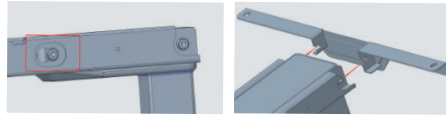

3. Single screw to adjust and fix the frame length

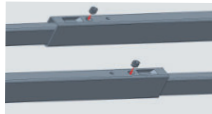

2. Pre-install Side bracket only 2 screws

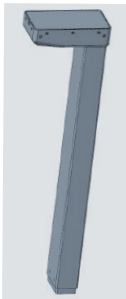
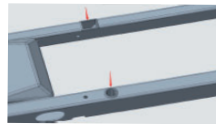

5. Column -

- Installation length: 650mm
- Stroke length: 495 mm
- Tube: 80x50; 70x45
- Force: Desk 800 N
- Speed: Desk 30 mm/sec.
- Low noise: Under 48 dB



4. Wooden screws to fix tabletop. Guiding parts through the frame.

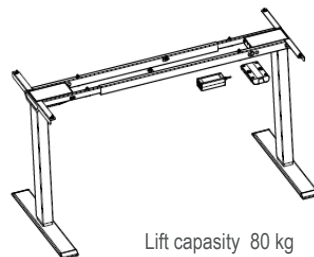
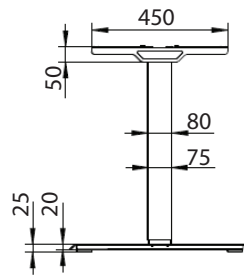
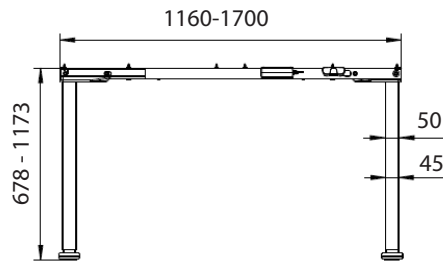

Lift capacity 80 kg

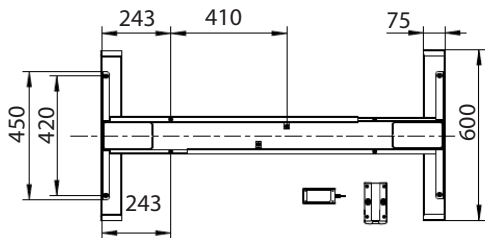

SCAN SØRLIE
NEW NORDIC DESIGN

Key Features:

- Lite 2.0 solution / Small Package size (793x228x135) / Light weight under 20 kg.
- Low noise under 48 dB / Adjustable frame (1160-1700 mm.)
- Build-in Standard anti collision

Cable management:

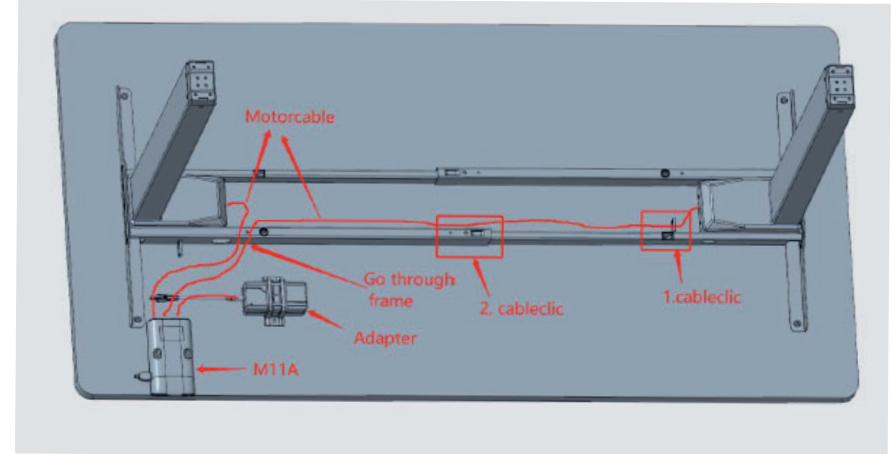

Cableclick 1



Frame

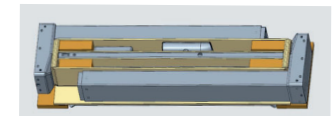

Electric parts

- 2in1 controlbox +SMPS
- Up/Down button
- Anti collision (Power)
- Standby power 0,1W
- 1 USB, 5V 2A output

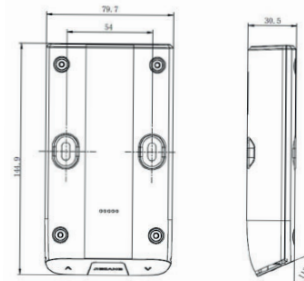

Manual

Download from website:
<https://scansorlie.no/produkt/up-lite-2-0-elektrisk-hev-senk-understell/>



SCAN SØRLIE
NEW NORDIC DESIGN